



Balanced Supply of Housing

Academic / Community Partnership

WINTER 2022 NEWSLETTER Happy Holidays!

December 2022



Check out this incredible video by Uytae Lee and [About Here](#) on **The Non-Capitalist Solution to the Housing Crisis**

Meet the Team!

Some incredible researchers joined the BSH team:



Dr. Julie Mah

Julie Mah is an Assistant Professor at the University of Toronto Scarborough in the Department of Human Geography – City Studies Program. Her research focuses on affordable housing issues, evictions, gentrification and displacement, and equitable development approaches. She received a PhD in planning from the University of Toronto and she has worked as a planning consultant on community improvement plans, cultural plans, and economic development strategies in small and mid-sized cities in Ontario. Her current research focuses on: (1) gentrification and evictions in Ontario; and (2) evaluating the effectiveness of value capture tools to generate new affordable housing in Toronto.

[Read More](#)



Kuni Kamizaki

Kuni Kamizaki is an Assistant Professor in the Department of Geography and Planning at the University of Toronto. His research adopts a multi-scalar approach to urban transformation with an emphasis on issues of poverty, displacement and housing inequality. His research combines political-economic accounts with neighbourhood-based ethnographic engagement to explore community-led initiatives for social and racial justice. He is currently engaged in two strands of research in Tokyo and Toronto. A first strand of research investigates the decline of world city Tokyo in the time of post-growth. A second strand focuses on the potential of community land trusts (CLTs) to challenge displacement and pursue housing justice.

[Read More](#)

We've been busy!

Check out what the BSH team has been up to:



Parkdale
Neighbourhood
Land Trust + Neighbourhood
Land Trust

Parkdale Tower Rental Housing Study

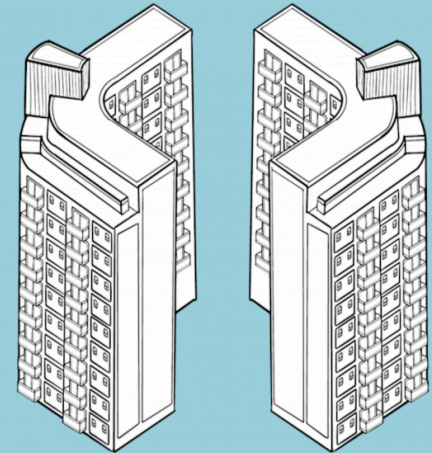

Full Report
Version 1
September 2022

The Impact of Financialization
and Gentrification by Upgrading on Parkdale's Rental Towers

Read our co-investigator, Dr. Penny Gurstein's publication in The Conversation: **If cities don't want homeless encampments they should help people, not punish them**

"Regardless of how they end up homeless, people deserve to be treated with dignity and understanding. Instead, shockingly, police have been carting away belongings from encampments, leaving people with few options of where to stay, other than another street or park. Even worse, evictions have turned violent."

Our partners at Parkdale Neighbourhood Land Trusts recently published a new research report: **Parkdale Tower Rental Housing Study**.

In 2020–21, NLT undertook the Parkdale Tower Rental Housing Study, an eight-month community-based action research project on the impact of financialization and gentrification on Parkdale's rental towers on housing affordability and tenant wellbeing. The study was conducted in collaboration with tenants and community partners, including the Parkdale People's Economy.

[Read Here](#)[Learn More](#)

Working towards a Balanced Supply of Housing

The BSH Node's co-investigators, community partners, and collaborators have engaged in meaningful research over the past year to tackle the complex problem of rising housing unaffordability in Canada. In this update, we're presenting a short description of the two important projects which the BSH funded in April 2022.



Policy Report & Profile Series on Canadian Community Land Trusts

Project Lead: Susanna Bunce
Co-investigators: Steve Pomeroy, Nicolas Gazzard, Penelope Gurstein, and Kuni Kamizaki

The Policy Report & Profile Series on Community Land Trusts (CLT) will be a collection of thematic reports produced by researchers and practitioners across the country that will discuss key issues related to the development and expansion of this important and under-researched alternative land practice. The

Building the Foundations of an Indigenous Women-Led Land Trust in Toronto

Project Lead: Tiffany Malley
Co-investigators: Alan Walks and Susannah Bunce

This project aims to establish the foundations for an Indigenous-led land trust to address the impact of the housing crisis on Indigenous women, children, and 2-Spirit communities in the land currently known as Toronto. The project will begin by drawing lessons from existing Indigenous-led land trusts

series will be written for popular audiences including CLT practitioners, community members, students, academics and government officials. The series will be produced and disseminated in partnership with the Canadian Network of Community Land Trusts (CNCLT). Through this partnership, the CNCLT will participate in the shaping of the themes to ensure relevance to practitioners and will connect researchers to member CLTs.

The series will include 2-5 Policy Papers tackling critical issues around CLT development and 2-5 shorter CLT Profiles documenting the models of particular CLTs.

such as Segorea Te Land Trust and Mno Aki to understand how these groups established their governance, policies, and practices for land stewardship. The community researcher will then organize a series of 2-3 storytelling circles with Indigenous mothers, life givers, elders, and 2-Spirit community members to understand community needs for affordable rental and/or home ownership models and visions for an Indigenous women-led land trust that centers sovereignty and self-determination. The circles will be accompanied by a survey circulated with Indigenous organizations and grassroots groups to share with their membership along with street outreach.

[Learn More](#)

[Learn More](#)

Let's Talk About 2023!



The CHRA's Congress on Housing and Homelessness is accepting session proposals for 2023!

[Submit a Proposal](#)

The BSH Node in the Web

To get information about the Balanced Supply of Housing and its projects, we invite you to visit the following websites.



[Click to Visit](#)



[Click to Visit](#)